

SONY®



- ▷ **Browsing this Guide using Sony Reader**
- ▷ **Jumps to the table of contents**

Operation Guide

PRS-500

Portable Reader System

About the Manuals

Included with Sony Reader is the Quick Start Guide and this PDF-format Operation Guide. Additionally, after installing CONNECT Reader software from the supplied CD-ROM, you can refer to the Help within CONNECT Reader.

Browsing the Operation Guide

This PDF-format Operation Guide can be browsed on both your computer and Sony Reader.

Browsing this Guide on your computer

Click the Start menu in the bottom left of the Desktop, then select “All programs” – “CONNECT Reader” – “PRS-500 Operation Guide” to start Adobe Acrobat Reader and open the Operation Guide.

For details on how to use Adobe Acrobat Reader, refer to the Adobe Acrobat Reader Help.

Hint



- To view the Operation Guide, you should have installed either Adobe Reader 5.0 or later. Adobe Reader can be downloaded for free from the Adobe website (www.adobe.com).

Browsing this Guide using Sony Reader

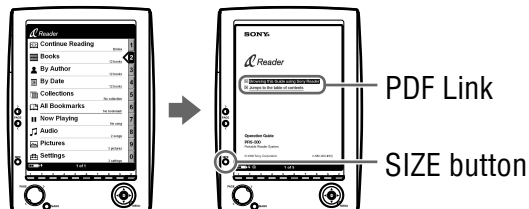
From the Home menu, select “Books” – “Operation Guide” from the Book list. The Operation Guide can be opened by selecting “Option Menu” – “Begin.”



Hints

- A  mark on this Guide indicates a link. Using the 5-way control button, press / to select the desired link, then press ENT to jump to the linked page.
- To zoom in a page, press SIZE.

For details on how to open books or PDF files, refer to  [page 32, 37](#).

Using the CONNECT Reader Help

Refer to the CONNECT Reader Help for details about using CONNECT Reader, such as importing books to your computer and transferring them to Sony Reader.

Follow the steps below to start CONNECT Reader and browse Help.

- 1 Click the Start menu, then select “All programs” – “CONNECT Reader” – “CONNECT Reader.”
- 2 Click “Help” – “CONNECT Reader Help” on the Menu bar.

Help appears.

Table of Contents

About the Manuals	2
Browsing the Operation Guide.....	2
Using the CONNECT Reader Help	3

Introduction

What You Can Do with Sony Reader	7
Guide to Parts and Controls.....	8

Basic Operations

Menu Operations	13
Turning on Sony Reader	15
Inserting a Memory Card	18

Importing Content

Importing eBooks from CONNECT eBooks.....	22
Importing Content from Your Computer	24
Importing content files	25

Transferring Content

Transferring Content to Sony Reader Connected with Your Computer	26
Transferring content via a memory card	28

Reading/Playing/Viewing Content

Reading Books.....	32
Reading books transferred from your computer	32
Switching screen orientation (vertical/horizontal)	37
Displaying the book information.....	38
Sorting the Book list	39
Selecting a book from the Collection list.....	40
Creating a bookmark on a page	41
Reading previously displayed pages	44
Playing Audio Files.....	45
Playing audio files transferred from your computer	45
Reading books while playing an audio file.....	47
Viewing Pictures	49
Viewing pictures transferred from your computer	49

Settings

Setting screen orientation	52
Locking the Sony Reader Screen.....	53
Setting the Slideshow	55
Checking Version Information for Sony Reader	56

Troubleshooting

Troubleshooting.....	57
Restoring default settings	63
Uninstalling CONNECT Reader	64

Other Information

Updating the Sony Reader's Firmware.....	65
About Books Pre-installed on Sony Reader	66
Notes on Sony Reader Disposal	67
Precautions.....	68
On safety	71
On installation.....	71
On heat build-up	72
On the headphones	72
Notes on memory cards	73
On software	75
On Cleaning.....	76
On Copyrights.....	77
About GNU GENERAL PUBLIC LICENSE.....	78
Specifications.....	80
Index.....	81

What You Can Do with Sony Reader

First, read the Quick Start Guide to prepare Sony Reader for use. Initially after purchase, you need to charge the Sony Reader battery and install the dedicated software “CONNECT Reader” on your computer. Once initial preparation is complete, you can transfer content from your computer to Sony Reader to take anywhere you wish.

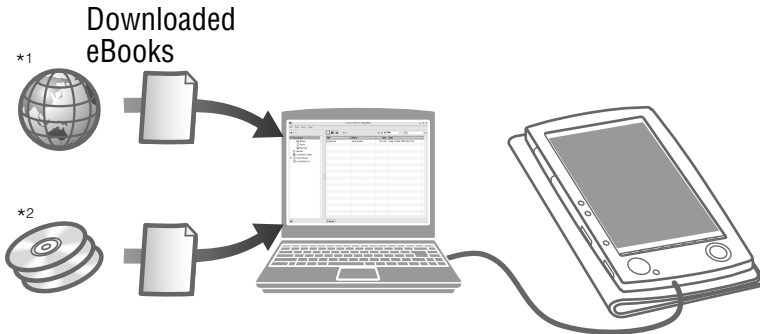

*1 CONNECT eBooks (online e-Book store)

*2 Audio/Picture/Text files that you already have

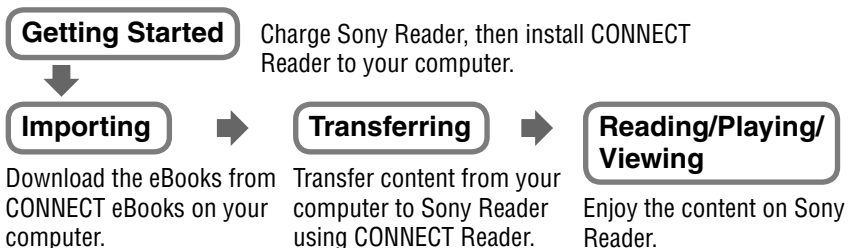

Guide to Parts and Controls

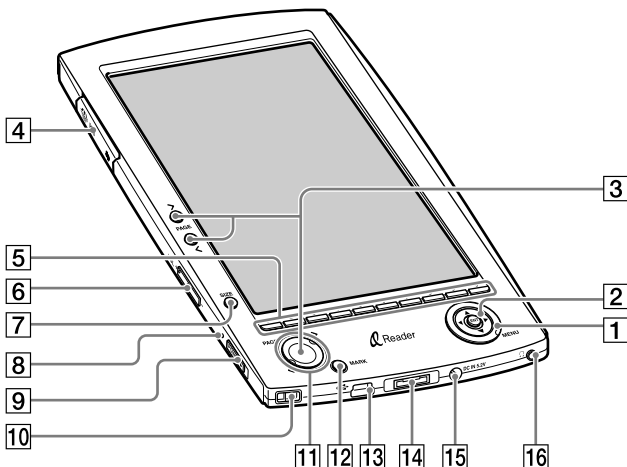

Front

1 MENU button

To return to the previous screen or show a menu. (> [page 13](#))

2 5-way control (◀/▲/▼/▶/ENT) button

To select an item or scroll around the screen, press the ENT button, left (◀), up (▲), down (▼), or right (▶).



ENT button

To decide an item or apply a setting, press down on the ENT button.

In this manual, the operation of the 5-way control button is explained as follows.

(Example) Press ◀/▲/▼/▶ to select “1984” on the Book list, then press ENT.

3 PAGE (>/<) buttons

To turn the page or proceed/return to the next (>)/previous (<) content. (☞ [page 32](#), [35](#), [47](#), [50](#))

4 Media slot

To insert a “Memory Stick” (optional) or SD Memory Card (optional). (☞ [page 19](#))

5 Number (1 – 9,0) buttons

To select the numbered items on the screen or input numeric values on the Setting menu. (☞ [page 32](#), [35](#), [45](#), [49](#))

6 VOLUME +/- buttons

To adjust the volume. (☞ [page 47](#))

7 SIZE button

To zoom in/out a page or picture. (☞ [page 36](#), [50](#))

8 Charge indicator

Lights up in red while charging, and goes off when charging is complete. (☞ [page 16](#))

Lights up in orange when Sony Reader is turned on.

9 POWER switch

To switch on/off Sony Reader. (☞ [page 15](#))

10 Hole for hand strap

To attach the hand strap.

11 MARK LED

Lights up in blue to confirm creation of a bookmark. (☞ [page 41](#))

12 MARK button

To create/remove a bookmark. (☞ [page 41](#))

13 USB connector

To connect the USB cable (supplied). ([▶ page 26](#))

14 Multi connector

To connect the optional cradle.

15 DC IN jack

To connect the AC power adapter (supplied).

16  (Headphones) jack

To connect headphones (optional). ([▶ page 45](#))

Rear

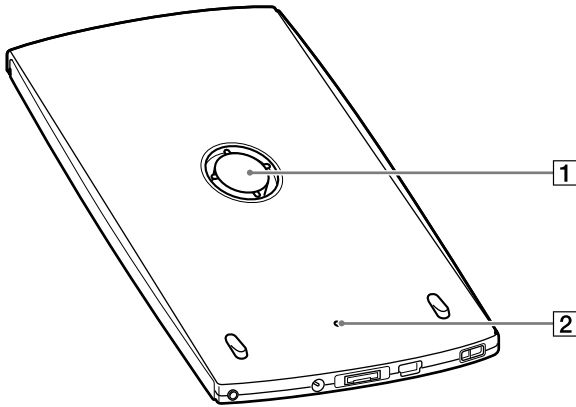

1 Soft cover attachment clip button

The soft cover is attached when purchased.

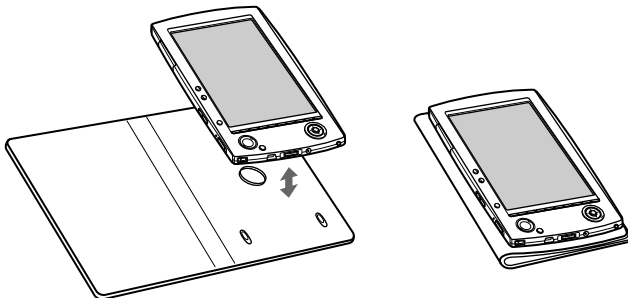

Removing/attaching the soft cover

Folds open in use

Note

- Do not leave Sony Reader in a high ambient temperature, as it may damage the soft cover.

2 Reset button

To reset Sony Reader if no operation is possible. ([page 57](#))

Hint

- Remove the soft cover to access the Reset button.

About the serial number

The serial number provided for Sony Reader is required for the customer registration. The number is on the label on the rear of Sony Reader. Do not remove the label.

Menu Operations

You can switch between screens, read/play/view content, or set items, using the 5-way control button, number buttons, or MENU.

Example: screen transition diagram of the Home menu – Book list – Option menu – Book page

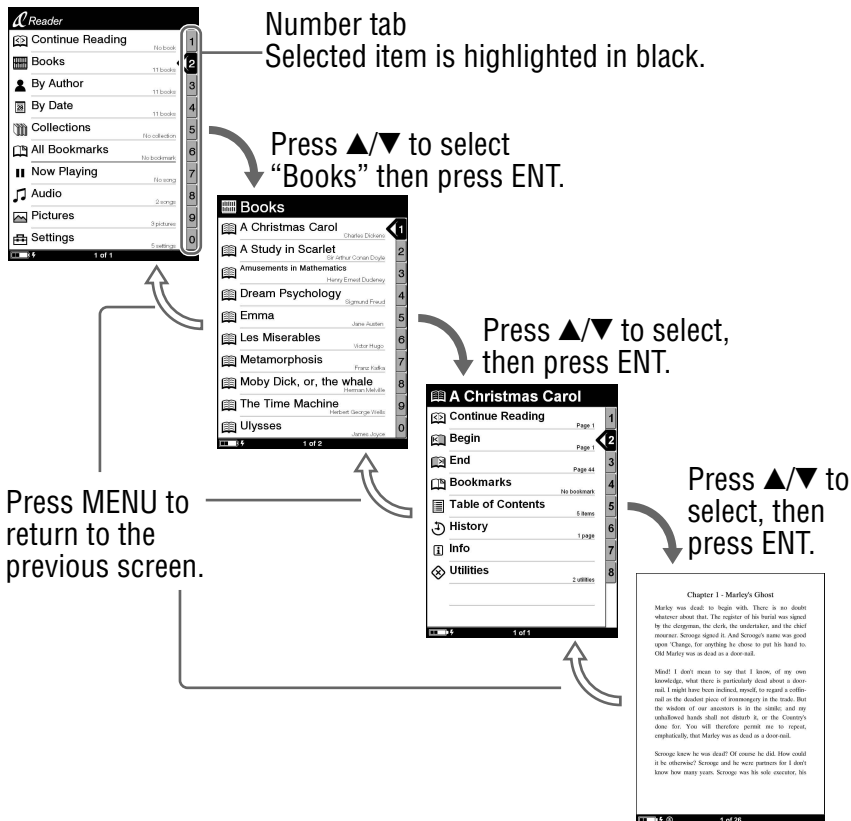

Hints

- By pressing and holding SIZE, screen orientation can be switched (vertically/horizontally). ( [page 37](#))
- By using the number buttons, corresponding numbered items can be selected.

Turning on Sony Reader

Slide the POWER switch in the direction of ► to turn on Sony Reader.

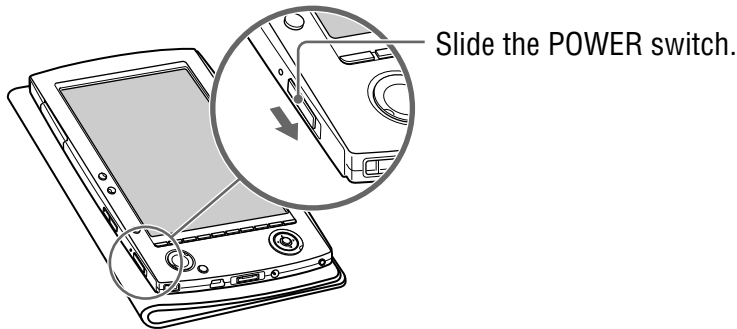

Sony Reader turns on.

The start-up screen appears when turning on for the first time, or after reset, or when the battery is depleted.

Lights up in orange when Sony Reader is turned on.

Note

- Sony Reader may take a few moments to turn on after charging a depleted battery.

To turn off Sony Reader

Slide the POWER switch in the direction of ► again.

Sony Reader turns off.

About the resume function

Sony Reader automatically turns off if no operation is performed for 60 minutes. The previously displayed screen appears when turning on by sliding the POWER switch from this state.

Note

- When playing audio files or viewing a slideshow, Sony Reader does not turn off even if no operation is performed for 60 minutes.

About charging

Charging Sony Reader is required when using for the first time. Sony Reader can be charged in the following 2 ways.

- Connect to an AC outlet (refer to the Quick Start Guide).
- Connect to a computer via USB ([▶ page 26](#)).

Notes

- If the remaining battery power of a connected notebook computer is low, charging via USB connection may not be possible.
- If you connect Sony Reader to a notebook computer which is not connected to an AC outlet, the battery of the notebook computer will be consumed. Do not leave Sony Reader connected to a notebook computer which is not connected to an AC outlet for an extended period.
- USB charge is not possible if the battery becomes depleted. Use the AC power adapter.

You can check remaining battery power by the indication in the bottom left of the screen. Charge the battery when remaining power is low (the fewer black segments indicated, the lower the remaining power).



Note

- If the remaining battery power is low, the following warning appears. Charge the battery.

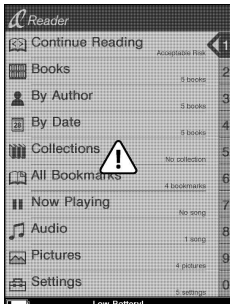

If you continue use without charging, the following warning appears, and Sony Reader will turn off automatically. Charge Sony Reader and turn it on again.

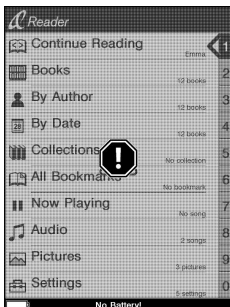

Inserting a Memory Card

The following memory cards can be inserted in the Media slot of Sony Reader.

“Memory Stick”^{*1}	“Memory Stick” “Memory Stick PRO” “Memory Stick Duo” ^{*3} “Memory Stick Pro Duo” ^{*3} Sony Reader is compatible with both “MagicGate Memory Stick” and standard “Memory Stick.”
SD Memory Card^{*2}	SD Memory Card miniSD Card ^{*4}

*1 Sony Reader does not comply with MagicGate standard, and the data requiring the copyright protection function cannot be copied or played on Sony Reader.

*2 Sony Reader does not comply with copyright protection of SD Memory Cards.

*3 “Memory Stick Duo” adaptor (sold separately) required.

*4 miniSD Card adaptor (sold separately) required.

Notes

- An operation check is performed when using a “Memory Stick” of up to 4 GB, however, operation of all “Memory Stick” is not guaranteed.
- An operation check is performed when using an SD Card of up to 2 GB, however, operation of all SD Cards is not guaranteed.

Inserting a memory card into Sony Reader

- 1 Open the Media slot cover.

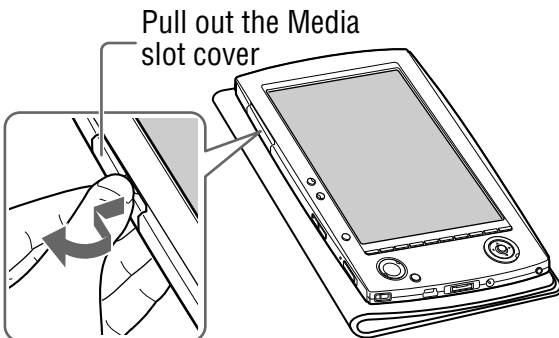

- 2 Insert a memory card in the ► direction with its label side up until it clicks into the place.

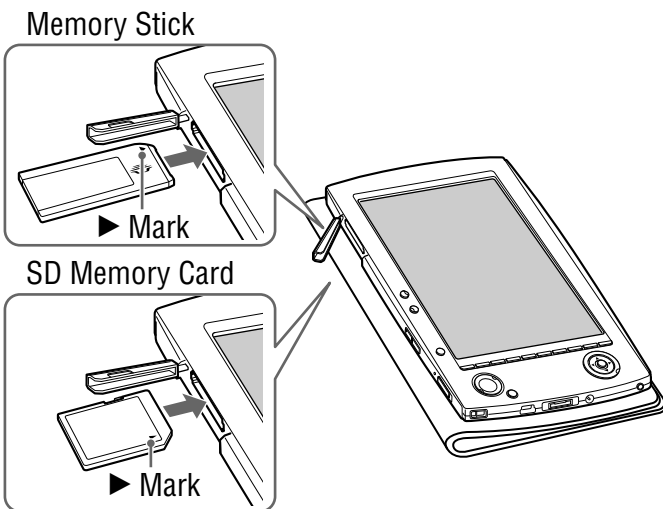

3 Close the Media slot cover.

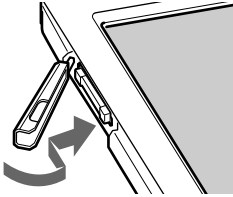

Notes

- Be sure to insert the memory card in the correct direction. Forced insertion may damage the slot.
- Do not insert an incompatible memory card, as it may cause malfunction.
- Do not use a deformed memory card or adaptor.

Removing a memory card from Sony Reader

1 Gently push in the memory card.

You will hear a click, and the memory card pops out.

Memory Stick

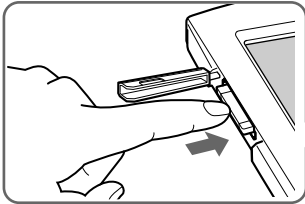

SD Memory Card

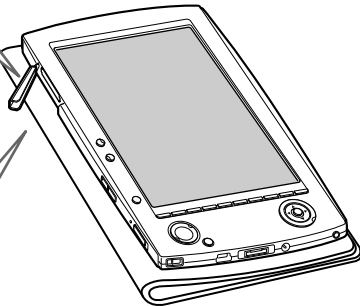
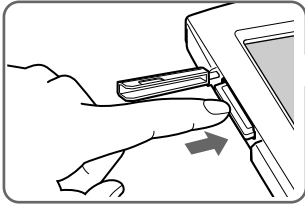

2 Remove the memory card squarely from the Media slot.

Notes

- Do not remove a memory card or turn off Sony Reader while reading or writing data, as data may be damaged.
- For details on handling memory cards, refer to [page 73](#).

Importing eBooks from CONNECT eBooks

You can download eBooks from the online e-Book store “CONNECT eBooks” to your computer.

Use the dedicated software CONNECT Reader to access CONNECT eBooks.

Notes

- To download eBooks, you need to prepare an Internet-accessible environment on your computer.
- You need to authorize your computer to CONNECT eBooks to download eBooks.
You also need to authorize Sony Reader to CONNECT eBooks to transfer and read downloaded eBooks on Sony Reader.
For details, refer to the CONNECT Reader Help.

1 Click the Start menu, then select “All programs” – “CONNECT Reader” – “CONNECT Reader” to start CONNECT Reader.

2 Click “eBook Store” in the Source view.
The View area is switched to the Store view and CONNECT eBooks appears.

3 Follow the page instructions to purchase (download).

Downloaded eBooks are automatically imported to “Library” in the Source view.

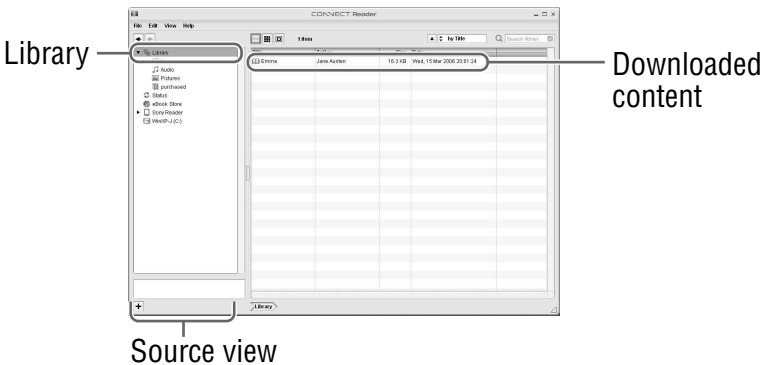

Hint

- Purchased eBooks are grouped under “Purchased” in the collection.

Hints

- eBooks can be read on CONNECT Reader using your computer. For details on CONNECT Reader operations, refer to the CONNECT Reader Help.
- The Source view appearance may vary depending on your computer.

Importing Content from Your Computer

You can import the content files stored on your computer into Library of CONNECT Reader.

You can import the following content files.

- Book
 - PDF file, Text file, RTF file, Word file*, BBeB Book
- Audio
 - MP3 file, AAC file
 - MP3 file (.mp3 file extension)
The following specifications should be met in order to import an MP3 file.
Bit rate: 32 to 320 kbps
Sampling frequency: 22.05, 44.1 kHz
 - AAC file (.mp4, .m4a, .mov, or .qt file extension)
The following specifications should be met in order to import an AAC file.
Bit rate: 40 to 320 kbps
Sampling frequency: 24.0, 44.1, 48.0 kHz
- Picture
 - Bitmap file, JPEG file, GIF file, PNG file

* Word files will be automatically converted into RTF files during transfer only if Microsoft Word is installed on your computer.

For details on content files you can import, refer to the CONNECT Reader Help.

Importing content files

You can select content files stored on your computer and import them into Library.

1 Click the Start menu, then select “All programs” – “CONNECT Reader” – “CONNECT Reader” to start CONNECT Reader.

2 Click “Import Files” on the “File” menu.
The “Import Files” dialog box appears.

3 Click  of the “Look in” list to select the folder containing the content file(s) to be imported, as necessary.

The content files in the selected folder are listed.

Hint

- You can also double-click the folder (in the folder list) to display the content files in the folder.

4 Select the content file to be imported.

To select multiple files, click the files while holding down the Ctrl key.

5 Click “Open.”

The content file(s) is imported into Library.

Hint

- You can import all the content files in a selected folder at the same time into Library from “Import Folder” on the “File” menu.

Transferring Content to Sony Reader Connected with Your Computer

You can transfer (copy) the content in Library to Sony Reader.

- 1** Click the Start menu, then select “All programs” – “CONNECT Reader” – “CONNECT Reader” to start CONNECT Reader.
- 2** Connect Sony Reader to your computer using the supplied USB cable.

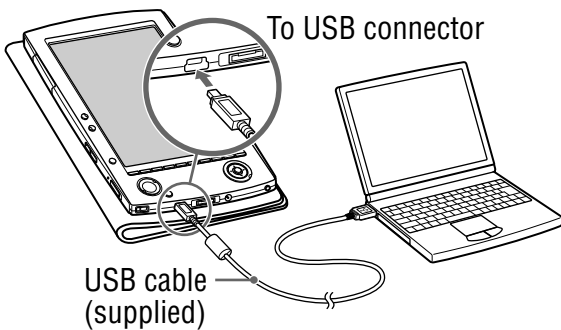

“Sony Reader” appears in the Source view of CONNECT Reader.

A screen appears on Sony Reader, indicating that it is connected to the computer.

Note

- If “Sony Reader” does not appear in the source view after connecting Sony Reader to your computer, disconnect the USB cable from Sony Reader, then reconnect it after a while. If the optional cradle is used, remove Sony Reader from the cradle, then replace it after a while.

3 Click “Library” in the Source view, then click (List view).

The View area is switched to the List view and all the content in Library is listed.

Hints

- When you click “Books,” “Audio” or “Pictures” in the Source view, only their respective content is displayed.
- When you click  (Thumbnail view), content can be displayed as thumbnails.

4 Select the content you want to transfer from the list.

To select multiple content, click the content while holding down the Ctrl key.

5 Drag the content from the list to “Sony Reader” in the Source view.

The content is transferred to Sony Reader.

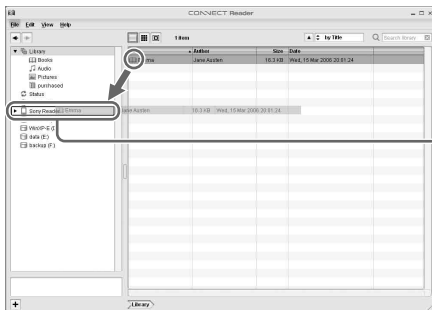

Sony Reader

Notes

- If there is not enough free space on Sony Reader's memory, content may not be transferable. Transfer any unnecessary content back to CONNECT Reader, then delete it to increase free space on Sony Reader. (➤ [page 30](#))
- You cannot delete or copy transferred content on Sony Reader. Perform data management on CONNECT Reader. For details on the CONNECT Reader operations, refer to the CONNECT Reader Help.

Transferring content via a memory card

Content imported to CONNECT Reader can be transferred to a memory card on Sony Reader.

Hint

- "Memory Stick" and SD Memory Card can be used.

1 Click the **Start** menu, then select **"All programs"** – **"CONNECT Reader"** – **"CONNECT Reader"** to start **CONNECT Reader**.

2 Connect **Sony Reader** to your computer using the supplied **USB cable**. (➤ [page 26](#))
"Sony Reader" appears in the **Source** view of **CONNECT Reader**.

3 Insert a **memory card** into the **Media slot** of **Sony Reader**. (➤ [page 19](#))
"Memory Stick/SD Card on Sony Reader" appears in the **Source** view.

4 Click “Library” in the Source view of CONNECT Reader, then click  (List view).

The View area is switched to the List view and all the content in Library is listed.

Hints

- When you click “Books,” “Audio” or “Pictures” in the Source view, only their respective content is displayed.
- When you click  (Thumbnail view), contents can be displayed as thumbnails.

5 Select the content you want to transfer from the list.

To select multiple content, click the content while holding down the Ctrl key.

6 Drag the content from the list to “Memory Stick/SD Card on Sony Reader” in the Source view.

The content is transferred to the memory card on Sony Reader.

Notes

- If there is not enough free space on the memory card, content may not be transferable. Transfer any unnecessary content back to CONNECT Reader, then delete it to increase free space on the memory card. ( [page 30](#))
- You cannot delete or copy transferred content on Sony Reader. Perform data management on CONNECT Reader. For details on CONNECT Reader operations, refer to the CONNECT Reader Help.

To transfer content back to **CONNECT** Reader

- 1 Click the Start menu, then select “All programs” - “CONNECT Reader” - “CONNECT Reader” to start CONNECT Reader.
-

- 2 Connect Sony Reader to your computer using the supplied USB cable. ( [page 26](#))
“Sony Reader” appears in the Source view.
-

- 3 Click “Sony Reader” in the Source view, then click  (List view).
The View area is switched to the List view and all the content in Library is listed.

Hints

- When you click “Books,” “Audio” or “Pictures” in the Source view, only their respective content is displayed.
 - When you click  (Thumbnail view), contents can be displayed as thumbnails.
-

- 4 Select the content you want to transfer back from the list.
To select multiple content, click the content while holding down the Ctrl key.
-

5 Drag the content from the list to “Library” in the Source view.

The content is transferred back to CONNECT Reader.

Reading Books

Reading books transferred from your computer

Follow the steps below to read books transferred from your computer.

- 1 In the Home menu, press ▲/▼ to select “Books,” then press ENT.

The Book list appears.

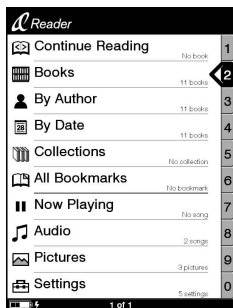

Indicates that the content is stored on the memory card.

Number tabs

Indicator

Hints

- The content on the memory card also appears in the Book list.
- In addition to ▲/▼, you can also select an item by pressing the same number button as indicated on the number tab.
- To display the rest of the list, press > (repeatedly).
- You can jump directly to the last displayed page by selecting “Continue Reading” from the Home menu, without displaying the Book list.
- If an invalid operation is performed, a circular icon with a diagonal slash appears at the bottom of the screen.

-
- 2 Press ▲/▼ to select the desired book from the list, then press ENT.**

The Option menu appears. ( [page 34](#))

Hint

- To return to the previous screen, press < or ◀.
- To proceed to the next screen, press > or ▶.

-
- 3 Press ▲/▼ to select how to open the book, then press ENT.**

To read the book from the beginning, press ▲/▼ to select “Begin,” then press ENT.

The first page of the book appears.

To open the book’s table of contents or the bookmarks of the PDF file, press ▲/▼ to select “Table of Contents,” then press ENT.

The table of contents/bookmarks appears (if contained in the book/PDF file).

Press MENU to close the book.

About the Option menu

The book title is displayed.

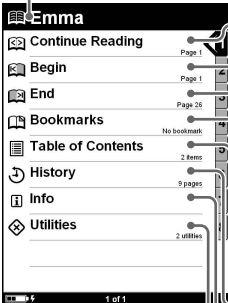

- To open the last displayed page.
- To open the first page of the book.
- To open the final page of the book.
- To open the Bookmark list. ([page 41](#))
- To open the table of contents of the book or the bookmarks of the PDF file, if contained in the book/PDF file.
- To open the list of previously displayed pages ([page 44](#))
- To display the book information. ([page 38](#))
- To remove bookmarks or clear history. ([page 43](#), [44](#))

Book types supported by Sony Reader

The following are the book types supported by Sony Reader and their characteristics.

eBook (.lrf and .lrx file extension)	A book in BBEB format that you can download from CONNECT eBooks. The link tool embedded in eBooks (page jumps, etc.) can be used. (page 37)
PDF file (.pdf file extension)	A File in PDF format (Version 1.4 or before) Bookmark and link tool on PDF files can be used.
Text file (.txt file extension)	

RTF file
(rtf. file extension)

An RTF file that is automatically converted from a Microsoft Word file.*

* Only if Microsoft Word is installed on your computer.

Operations on the Book page screen

On the Book page screen, the following operations can be performed.

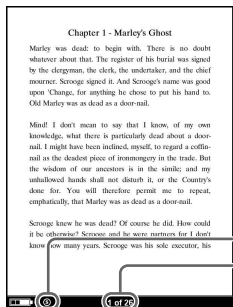

Size indicator

Current page number/
total page number

Button	Operation
> button	To proceed to the next page (press); jump 10 pages ahead of the current page (press and hold).
< button	To return to the previous page (press); jump 10 pages back from the current page (press and hold).
Number buttons	To jump to a page a certain percentage (10× the number pressed) of the way into the book. For example, button 3 represents 30 % of the way into the book.

Button	Operation
SIZE button	<p>To zoom in/out a page. Every time you press SIZE, the page is magnified in steps and returns to the original scale after the maximum magnification.</p> <ul style="list-style-type: none"> • When reading an eBook or Text file: The scale switches in 3 steps (🔍, 🔍, 🔍 – indicated at the bottom of the screen). • When reading a PDF file: The scale switches between “Fit width” (page fits the width of window) and “Fit Visible” (texts and graphics fit the width of window). • By pressing and holding SIZE for a few seconds, screen orientation can be switched (vertically/horizontally). (📄 page 37)
MARK button	<p>To create/remove a bookmark on the current page (press) (📄 page 41, 43); Jump to the All Bookmark screen (press and hold).</p>
MENU button	To close the page and return to the Option menu.

To use the link tool of eBooks/PDF files on Sony Reader

When an eBook or a PDF file is displayed, you can use the embedded link tool.

The link appears highlighted on the screen. Press ENT to open the linked content or jump to the linked page.

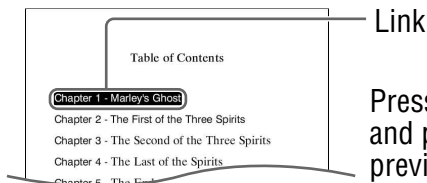

Press ▲/▼ to select the desired link, and press ◀/▶ to return to the previously displayed page.

Switching screen orientation (vertical/horizontal)

Screen orientation (including menu screens) can be switched in the following 2 ways.

- Press and hold SIZE on a menu screen or a Book page screen.
Press and hold SIZE again to switch back.
- Configure the setting from the Setting menu. ([☒ page 52](#))

About screen division when screen orientation is set to horizontal

When set to horizontal, the Book page is divided into 2 parts (upper and lower). To display the lower part, press >.

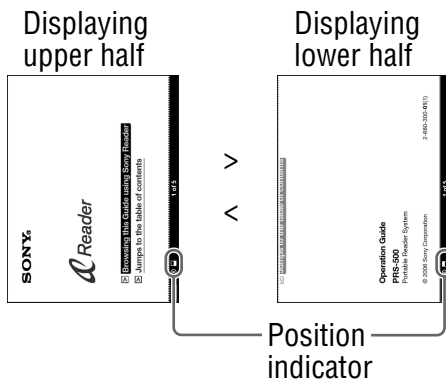

Displaying the book information

You can display the book information, such as the title, author, book cover thumbnail, etc.

- 1 In the Option menu, press ▲/▼ to select “Info,” then press ENT.**

The book information appears.

Sorting the Book list

On the Book list, books are sorted by title alphabetically. You can also sort books by author or date.

- 1 In the Home menu, press ▲/▼ to select “By Author” or “By Date,” then press ENT.

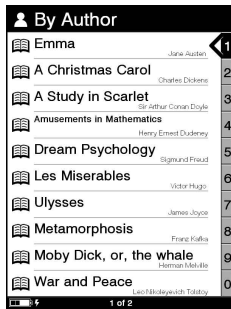
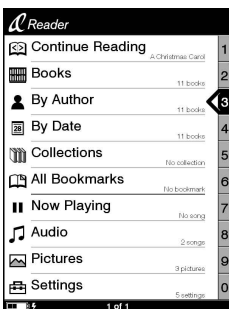

Hint

- If you select “By Date,” books are sorted by date transferred to Sony Reader.

- 2 Press ▲/▼ to select the desired book from the list, then press ENT.

The Option menu appears.

- 3 Press ▲/▼ to select how to open the book, then press ENT.

Selecting a book from the Collection list

You can select and read a book from the list of collections created on CONNECT Reader.

Hint

- For details on how to create or transfer a collection, refer to the CONNECT Reader Help.

1 In the Home menu, press ▲/▼ to select “Collections,” then press ENT.

The Collection list appears.

2 Press ▲/▼ to select the desired collection from the list, then press ENT.

The Book list appears.

3 Select the desired book from the list, then press ENT.

Creating a bookmark on a page

You can create a bookmark on a page you may wish to return to.

1 On the Book page screen, press MARK on the desired page.

The MARK LED lights up, and the mark appears in the top right corner of the page.

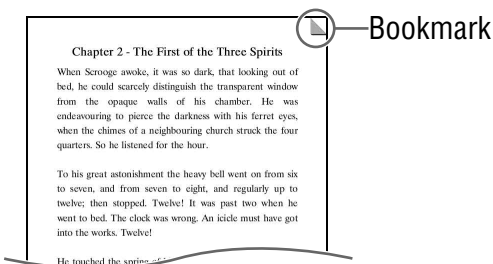

If you press MARK again, the bookmark will be removed.

Note

- When creating a bookmark, Sony Reader records the current page and the current page scale. Therefore, even on the same page, if the scale is switched and another bookmark created, the bookmarks will be stored at their respective scales.

To open the desired page from the Bookmark list

- 1 In the Option menu, press ▲/▼ to select “Bookmarks,” then press ENT.

The Bookmark list appears.

- 2 Press ▲/▼ to select the desired page, then press ENT.
-

Hint

- Bookmarks can also be created on CONNECT Reader. The bookmarks created on Sony Reader or CONNECT Reader will be retained when you transfer books between Sony Reader and CONNECT Reader. If you transfer a book back to CONNECT Reader from Sony Reader, the bookmarks created on Sony Reader will overwrite those in the book on CONNECT Reader, and vice versa.

To remove all bookmarks in the current book

- 1 In the Option menu, press ▲/▼ to select “Utilities,” then press ENT.
-

- 2 Press ▲/▼ to select “Remove All Bookmarks,” then press ENT.

All bookmarks in the current book are removed.

Note

- Confirm carefully before removing bookmarks.
-

To select from the list of all bookmarks on Sony Reader

- 1 In the Home menu, press ▲/▼ to select “All Bookmarks,” then press ENT.

The list of all bookmarks on Sony Reader appears.

- 2 Press ▲/▼ to select the desired page, then press ENT.
-

Hint

- The All Bookmark list can also be displayed by pressing and holding MARK.

Reading previously displayed pages

Sony Reader stores all displayed pages in memory for easy recall at any time.

- 1 On the **Book page** screen, press ◀.

As you press ◀ repeatedly, previously displayed pages appear in reverse order.

To show the displayed page history

- 1 In the **Option menu**, press ▲/▼ to select “**History**,” then press **ENT**.

The History list appears.

To clear History

- 1 In the **Option menu**, press ▲/▼ to select “**Utilities**,” then press **ENT**.

- 2 Press ▲/▼ to select “**Clear History**,” then press **ENT**.
History data of the current book is cleared.

Note

- Confirm carefully before clearing History.
-

Playing Audio Files

Playing audio files transferred from your computer

MP3/AAC files can be played back on Sony Reader. You can also read books while listening to an audio file. ([page 47](#))

When listening to audio files, connect the optional headphones to the headphone jack.

- 1** In the Home menu, press **▲/▼** to select “Audio,” then press **ENT**.

The Audio list appears.

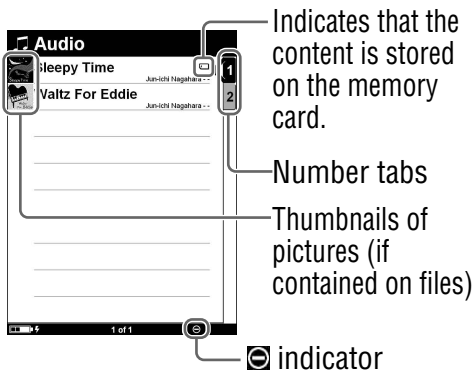
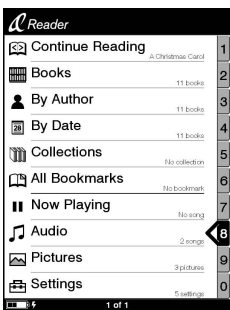

Hints

- The content on the memory card also appears in the Audio list.
- In addition to **▲/▼**, you can also select an item by pressing the same number button as indicated on the number tab.
- To display the rest of the list, press **>** (repeatedly).
- If an invalid operation is performed,  appears at the bottom of the screen.

- If an audio file is played, “Now Playing” can be selected on the Home menu and the Playback screen can be displayed.
- The Now Playing icon in the Home menu changes when an audio file is being played.

2 Press ▲/▼ to select the desired track from the list, then press ENT.

Playback starts.

Tracks are played in alphabetical order.

To stop playback, press ENT.

Operations on the Playback screen

On the Playback screen, the following operations can be performed.

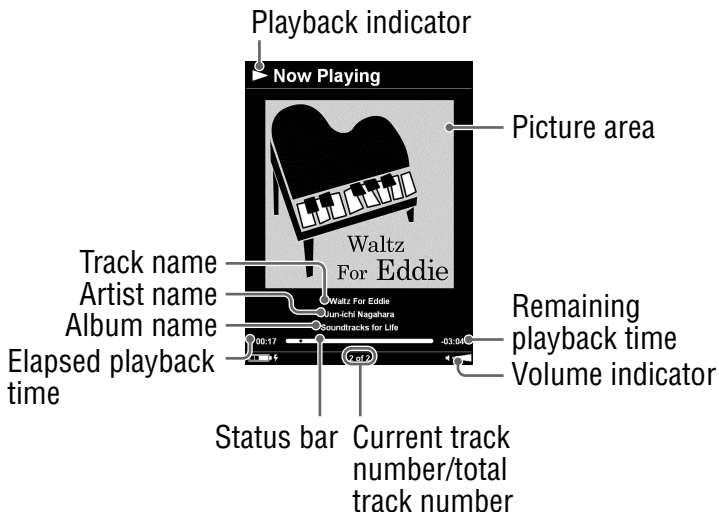

Button	Operation
> button	To skip to the next track.
< button	To skip to the previous track.
◀/▶	To rewind/fast-forward the track.
ENT button	To stop/restart playing the track.
VOLUME +/- buttons	To adjust the volume.

Reading books while playing an audio file

You can read books while listening to an audio file.

- 1 In the Home menu, press ▲/▼ to select “Audio,” then press ENT.**
The Audio list appears.
- 2 Press ▲/▼ to select the desired track from the list, then press ENT.**
Playback starts.
- 3 Press MENU to return to the Home menu.**
- 4 Press ▲/▼ to select “Books,” then press ENT.**
The Book list appears.
- 5 Press ▲/▼ to select the desired book from the list, then press ENT.**
The Option menu appears.

6 Press ▲/▼ to select how to open the book, then press ENT.

The Book page screen appears.

While an audio file is played, the volume indicator  appears at the bottom of the screen.

Hint

- To stop playback, press MENU 3 times to return to the Home menu, select “Now Playing” using ▲/▼ and ENT, then press ENT on the Playback screen.

Viewing Pictures

Viewing pictures transferred from your computer

BMP/JPEG/GIF/PNG files can be viewed on Sony Reader.

- 1 In the Home menu, press ▲/▼ to select “Pictures,” then press ENT.

The Picture list appears.

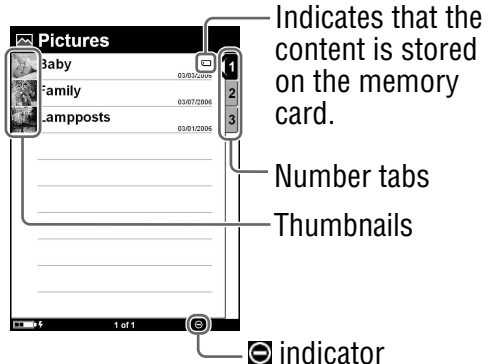
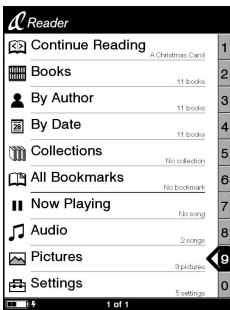

Hints

- The content on the memory card also appears in the Picture list.
- In addition to ▲/▼, you can also select an item by pressing the same number button as indicated on the number tab.
- To display the rest of the list, press > (repeatedly).
- If an invalid operation is performed, ⏏ appears at the bottom of the screen.

- 2 Press ▲/▼ to select the desired picture from the list, then press ENT.

The Picture appears.

Operations on the Picture viewer

On the Picture viewer, the following operations can be performed.

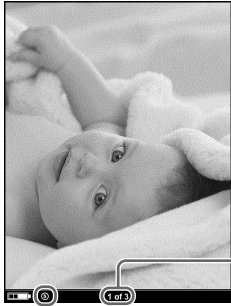

Current picture number/
total picture number

Size indicator

Button	Operation
> button	To display the next picture.
< button	To display the previous picture.
SIZE button	To zoom in/out a page. Every time you press SIZE, the picture is magnified in steps and returns to the original scale after the maximum magnification. The scale switches in 3 steps (S, M, L – indicated at the bottom of the screen).
ENT button	To restore the original scale when the picture is magnified.

To scroll the magnified picture

If you zoom in the picture by pressing SIZE, ◀/▲/▶/▼ appear at the edges of the screen.

Press ◀/▲/▼/▶ to scroll the screen.

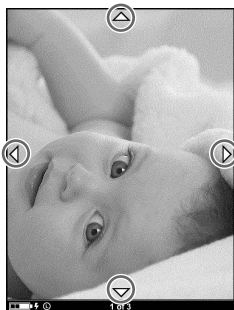

To view a slideshow of pictures

You can view a slideshow of pictures.

With the slideshow set to on, select the desired picture with which to start the slideshow from the Picture list.

The slideshow setting can be configured from the Setting menu (▶ [page 55](#)).

Setting screen orientation

Screen orientation (including menu screens) can be set to vertical/horizontal.

- 1 In the Home menu, press ▲/▼ to select “Settings,” then press ENT.

The Setting menu appears.

- 2 Press ▲/▼ to select “Orientation,” then press ENT.

The orientation is switched from vertical to horizontal.

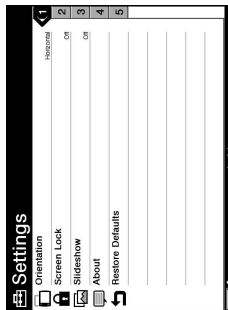
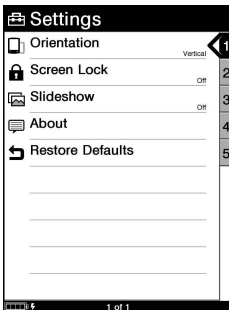

Locking the Sony Reader Screen

You can lock the Sony Reader screen by setting a password. Follow the steps below.

-
- 1 In the Home menu, press ▲/▼ to select “Settings,” then press ENT.**

The Setting menu appears.

-
- 2 Press ▲/▼ to select “Screen Lock,” then press ENT.**

The Screen Lock setting screen appears.

-
- 3 Press ENT repeatedly to select “OFF” or “ON.”**

The setting switches from “OFF” to “ON,” and the screen lock setting is activated.

-
- 4 Press ▼/◀/▶ to select “Code,” then press the number buttons to input the password.**

The 4-digit password is set.

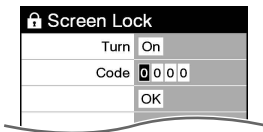

-
- 5 Press ▲/▼/◀/▶ to select “OK,” then press ENT.**

Once the password is set, next time you turn on Sony

Reader, the screen asking for the password appears. Press the number buttons to input the password, press ▼ to select “OK,” then press ENT. The Home menu appears.

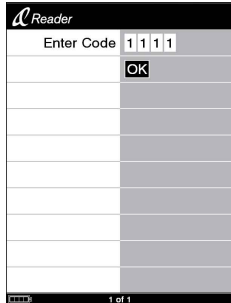

Note

- Be careful not to forget the password. If you lost your password, please call Sony Support 1-(866)-962-7669.

Setting the Slideshow

Follow the steps below to configure the slideshow settings.

- 1 In the Home menu, press ▲/▼ to select “Settings,” then press ENT.**

The Setting menu appears.

- 2 Press ▲/▼ to select “Slideshow,” then press ENT.**

The Slideshow setting screen appears.

- 3 Press ENT repeatedly to select “OFF” or “ON.”**

The setting switches from “OFF” to “ON,” and the slideshow setting is activated.

- 4 Press ▼/◀/▶ to select “Slide Duration,” then press the number buttons to input the duration time.**

“Slide Duration” can be set up to 60 seconds in 1 second increments.

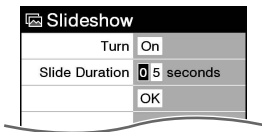

- 5 Press ▲/▼/◀/▶ to select “OK,” then press ENT.**
-

Checking Version Information for Sony Reader

The product name and the firmware version of Sony Reader can be displayed.

- 1 In the Home menu, press ▲/▼ to select “Settings,” then press ENT.**

The Setting menu appears.

- 2 Press ▲/▼ to select “About,” then press ENT.**

The About screen appears.

Troubleshooting

If Sony Reader does not function as expected, try the following steps to resolve the issue.

1 Reset Sony Reader by pressing the Reset button with a small pin or clip.

The content and settings stored on Sony Reader are not affected by resetting, and no information is erased. After pressing the Reset button, turn on Sony Reader by sliding the POWER switch.

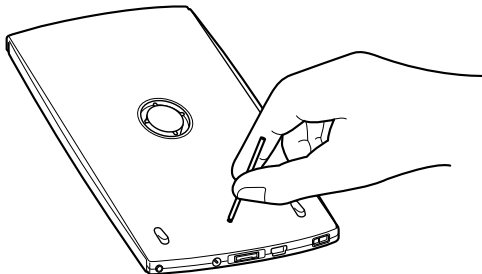

2 Check the symptoms in “Troubleshooting.”

3 Check for information about the issue in CONNECT Reader Help.

4 Look for information about the issue on one of the support Web sites.

<http://www.sony.com/readersupport>

5 If the approaches listed above fail to resolve the issue, please call Sony Support 1-(866)-962-7669.

Power

Symptom	Cause or corrective action
Battery life seems short.	<ul style="list-style-type: none">→ The operating temperature is below 5 °C (41 °F). This is due to the battery characteristics and not a malfunction.→ You have not used Sony Reader for a prolonged period. Efficiency of the battery will be improved by repeatedly charging and discharging.→ The battery needs to be replaced. Consult your nearest Sony Service Center.→ The battery has not been given enough time to charge fully. Charge the battery until the Charge indicator goes off. (The battery icon does not indicate remaining battery power during charging.)
Sony Reader cannot be turned on.	<ul style="list-style-type: none">→ Moisture condensation may have occurred. Wait for a few hours and then turn on Sony Reader.→ If the battery is depleted, charge the battery using the AC power adapter, as USB charge is not possible (▶ page 16).

Screen

Symptom	Cause or corrective action
It takes time for the display to appear.	<ul style="list-style-type: none">→ In a cold place such as outdoors, it may take time for the display to appear. This is due to the display characteristics and not a malfunction.

Reading/playing/viewing contents

Symptom	Cause or corrective action
A book cannot be read.	→ A book with copyright protection cannot be read on any device other than the authorized one.
An audio file cannot be played back.	→ Audio files that are not supported by Sony Reader cannot be played. For details on supported audio files, refer to ☒ page 45 .
Sound is not output.	→ Raise the volume if it is set low. → If sound is not output through headphones, make sure the headphone plug is firmly inserted in the headphone jack.
A picture cannot be displayed.	→ Picture files that are not supported by Sony Reader cannot be viewed. For details on supported picture files, refer to ☒ page 49 . → A picture of large size may not be displayable, and its file will not appear in the list. Delete the picture file using CONNECT Reader.
The data on Continue Reading, Bookmark or History of some files is missing.	→ If the file status has changed (such as in the following cases), the data on Continue Reading, Bookmark or History may be deleted. <ul style="list-style-type: none">• A Text/RTF/PDF file is edited.• An eBook purchased with a authorized Sony Reader is read on another de-authorized Sony Reader by memory card transfer.

Connection to the computer

Symptom	Cause or corrective action
Sony Reader cannot be operated during USB connection.	→ Sony Reader cannot be operated while it is connected to a computer.
Sony Reader cannot be recognized.	<p>→ Is the power of Sony Reader turned on? Is the USB cable connected properly? Verify the above and try again.</p> <p>→ Are you using a USB hub or USB extension cable? Connecting Sony Reader via a USB hub or extension cable may not work and is not supported. Connect the USB cable directly to the computer.</p> <p>→ Verify that  (indicating connection via USB) is displayed at the top of the Sony Reader screen. If Sony Reader still cannot be recognized, disconnect the USB cable from Sony Reader, then reconnect it after a while. If the optional cradle is used, remove Sony Reader from the cradle, then replace it after a while.</p>
Content cannot be transferred to Sony Reader from your computer.	<p>→ The USB cable is not connected properly. Disconnect the USB cable, then reconnect it.</p> <p>→ There is not enough free space on Sony Readers memory. Transfer any unnecessary content back to CONNECT Reader, then delete it to increase free space on Sony Reader.</p>

Connection to the computer (continued)

Symptom	Cause or corrective action
There is no response from CONNECT Reader during communication with Sony Reader.	→ Disconnect the USB cable from Sony Reader, then reconnect it.
Sony Reader becomes unstable while it is connected to the computer.	→ Are you using a USB hub or USB extension cable? Connecting Sony Reader via a USB hub or extension cable may not work and is not supported. Connect the USB cable directly to the computer.

eBook

Symptom	Cause or corrective action
An eBook cannot be read.	→ You may not have signed up for the service or authorized which is necessary for reading eBooks. Authorize your computer and Sony Reader. → You may have tried to read the content owned by another user. The content owned by another user cannot be read. → The authorization data may be damaged caused by a shut down while reading an eBook. De-authorize your computer and Sony Reader, then authorize again.

Memory card

Symptom	Cause or corrective action
Content on a memory card cannot be read/played/viewed.	<ul style="list-style-type: none">→ Check that the memory card is inserted in the Media slot in the correct direction.→ Clean the terminal area of memory card gently with a soft cloth if it is dirty.
Content cannot be transferred to a memory card.	<ul style="list-style-type: none">→ Release the erasure prevention switch if it is locked.→ There is not enough free space on the memory card. Delete unnecessary data.
A memory card cannot be recognized.	<ul style="list-style-type: none">→ A memory card which is not formatted with FAT may not be able to be recognized on CONNECT Reader. When formatting a memory card, format it using the formatter supplied with the memory card, or using Windows Explorer by specifying FAT.

Restoring default settings

All default settings of Sony Reader can be restored.

Notes

- The following occurs when you restore default settings. Perform any necessary operations beforehand.
- The password will be erased and the screen lock released.

1 In the Home menu, press ▲/▼ to select “Settings,” then press ENT.

The Setting menu appears.

2 Press ▲/▼ to select “Reset Defaults,” then press ENT.

The Reset Defaults screen appears.

If “Screen Lock” ([page 53](#)) is set to “ON,” the screen asking for the password appears. Input the password, then select “OK.”

3 Press MARK to restore default settings.

Uninstalling CONNECT Reader

To uninstall the supplied software from your computer, follow the procedures below.

Note

- Before uninstalling, de-authorize your computer if it is authorized. For details on de-authorization, refer to the CONNECT Reader Help.

1 Click “Start” – “Control Panel.”

2 Double-click “Add/Remove Programs.”

3 Click “CONNECT Reader” in the “Currently Installed Programs” list, then click “Change and Remove.”

Follow the on-screen instructions and restart your computer. The uninstallation is complete when the computer has restarted.

Updating the Sony Reader's Firmware

By updating the Sony Reader's firmware, you can ensure your Sony Reader has the latest features. The latest firmware updates can be performed from the update menu on CONNECT Reader from "Help" – "Check for Updates." For details on updates, refer to the CONNECT Reader Help or the following website.
<http://www.sony.com/readersupport>

About Books Pre-installed on Sony Reader

Sony Reader is pre-installed with sample data so that you can try it out right away. The pre-installed sample data is for the purpose of trial reading, viewing and listening.

Notes on Sony Reader Disposal

The built-in rechargeable battery of Sony Reader is recyclable. Do not remove the battery yourself, consult “Sony Portable Reader System Support Center” ([page 70](#)).



Li-ion Mn

Precautions

Owner's Record

The model and serial numbers are located on the back of the unit. Record the serial number in the space provided below. Refer to these numbers whenever you call upon your Sony dealer regarding this product.

Model No. _____

Serial No. _____

WARNING

To reduce the risk of fire or electric shock, do not expose this apparatus to rain or moisture.

Do not install the appliance in a confined space, such as a bookcase or built-in cabinet.

To reduce the risk of fire or electric shock, do not place objects filled with liquids, such as vases, on the apparatus.

Connect the AC power adapter to an easily accessible AC outlet. Should you notice an abnormality in the AC power adapter, disconnect it from the AC outlet.

For Customers in the USA

INFORMATION:

This equipment has been tested and found to comply with the limits for a Class B digital device, pursuant to Part 15 of the FCC Rules. These limits are designed to provide reasonable protection against harmful interference in a residential installation. This equipment generates, uses, and can radiate radio frequency energy and, if not installed and used in accordance with the instructions, may cause harmful interference to radio communications.

However, there is no guarantee that interference will not occur in a particular installation. If this equipment does cause harmful interference to radio or television reception, which can be determined by turning the equipment off and on, the user is encouraged to try to correct the interference by one or more of the following measures:

- Reorient or relocate the receiving antenna.
- Increase the separation between the equipment and receiver.
- Connect the equipment into an outlet on a circuit different from that to which the receiver is connected.
- Consult the dealer or an experienced radio/TV technician for help.

You are cautioned that any changes or modifications not expressly approved in this manual could void your authority to operate this equipment.

If you have any questions about this product:

Visit:

www.sony.com/readersupport

Contact:

Sony Portable Reader System Support Center at 1-(866)-962-7669

Write:

Sony Customer Information Services Center
12451 Gateway Blvd., Fort Myers, FL 33913

Declaration of Conformity

Trade Name: SONY
Model No.: PRS-500
Responsible Party: Sony Electronics Inc.
Address: 16530 Via Esprillo,
San Diego, CA 92127
U.S.A.
Telephone Number: 858-942-2230

This device complies with Part 15 of the FCC Rules. Operation is subject to the following two conditions: (1) This device may not cause harmful interference, and (2) this device must accept any interference received, including interference that may cause undesired operation.

For Customers in the USA and Canada

RECYCLING LITHIUM-ION BATTERIES

Lithium-ion batteries are recyclable.

You can help preserve our environment by returning your used rechargeable batteries to the collection and recycling location nearest you.



For more information regarding recycling of rechargeable batteries, call toll free 1-800-822-8837, or visit <http://www.rbc.org/>.

Caution: Do not handle damaged or leaking Lithium-ion batteries.

On safety

- Do not insert any foreign objects in the DC IN jack of Sony Reader.
- Be sure not to short-circuit the terminals of Sony Reader with metallic objects.

On installation

- Never subject Sony Reader to extremes of light, temperature, moisture or vibration.
- Never wrap Sony Reader in anything when it is being used with the AC power adapter. Heat build-up in Sony Reader may cause malfunction or damage.

On heat build-up

Heat may build up in Sony Reader while charging, or if it is used for an extended period of time.

On the headphones

Road safety

Do not use headphones while driving, cycling, or operating any motorized vehicle. It may create a traffic hazard and is illegal in many areas. It can also be potentially dangerous to play at a high volume while walking, especially at pedestrian crossings. You should exercise extreme caution or discontinue use in potentially hazardous situations.

Preventing hearing damage

Avoid using the headphones at a high volume. Hearing experts advise against continuous, loud and extended play. If you experience a ringing in your ears, reduce the volume or discontinue use.

Caring for others

Keep the volume at a moderate level. This will allow you to hear outside sounds and to be considerate to the people around you.

Warning

If lightning occurs while you are using Sony Reader, take off the headphones immediately.

About “Memory Stick”

“Memory Stick” is a high-capacity compact IC recording media. Not only can you exchange data among “Memory Stick” compatible devices, but also you can use as an external removable data storage.

About SD Memory Card

SD Memory Card complies with compact memory card standard and is commonly used as a storage media for digital still cameras.

For details on memory cards supported by Sony Reader, refer to “Inserting a Memory Card” on [page 18](#).

Notes on handling memory cards

- When using “Memory Stick Duo” on Sony Reader, an adaptor (sold separately) is required.
- When using miniSD Card on Sony Reader, an adaptor (sold separately) is required.
- Sony Reader does not comply with the following:
 - MagicGate standard.
 - copyright protection of SD Memory Cards.
 - high-speed transfer of SD Memory Cards.

- You cannot record or delete data stored in a memory card when its erasure prevention switch is locked.

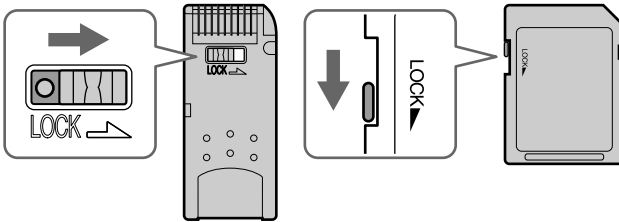

- Keep a memory card in its case when you carry or store it.
- Do not touch the connector of a memory card with bare hands or metallic objects.
- Do not bend, drop, or subject a memory card to excessive shock.
- Do not disassemble or modify a memory card.
- Do not allow a memory card to get wet.
- Avoid the following to prevent data damage. Sony does not provide any guarantee for damaged data.
 - Remove a memory card or turn off Sony Reader while reading or writing data.
 - Operate Sony Reader in the location where static charge or electrical noise is present.
- Do not use a label other than the dedicated one in the label area.
- Do not use or store Sony Reader in a location subject:
 - extreme high temperature, such as in a sun-heated car.
 - direct sunlight.
 - high humidity or places with corrosive substances.

On software

- Copyright laws prohibit reproducing the software or the manual accompanying it in whole or in part, or renting the software without the permission of the copyright holder.
- In no event will SONY be liable for any financial damage, or loss of profits, including claims made by third parties, arising out of the use of the software supplied with this Sony Reader.
- In the event a problem occurring with this software as a result of defective manufacturing, SONY will replace it. However, SONY bears no other responsibility.
- The software provided with this Sony Reader cannot be used with equipment other than that which is so designated.
- Please note that, due to continued efforts to improve quality, software specifications may be changed without notice.
- Operation of this Sony Reader with software other than that provided is not covered by the warranty.
- The ability to display the languages on your CONNECT Reader will depend on the OS installed on your computer. For better results, please ensure that the installed OS is compatible with the desired language you want to display.
 - We do not guarantee all the languages will be able to be displayed properly on your CONNECT Reader.
 - User-created characters and some special characters may not be displayed.
- Explanations in this manual assume that you are familiar with the basic operations of Windows. For details on the use of your computer and operating system, please refer to the respective manuals.

On Cleaning

- Clean the Sony Reader's case with a soft cloth, such as a cleaning cloth for eyeglasses.
- If the Sony Reader's case becomes very dirty, clean it with a soft cloth slightly moistened with water or a mild detergent solution.
- Do not use any type of abrasive pad, scouring powder, or solvent, such as alcohol or benzene, as it may mar the finish of the case.
- Be careful not to let water get into Sony Reader from the opening near the connector.
- Clean the headphone plug periodically.

If you have any questions or problems concerning Sony Reader, consult your nearest Sony dealer.

Notes

- Recorded content is limited to private use only. Use of the content beyond this limit requires permission of the copyright holders.
- Sony is not responsible for incomplete recording/downloading or damaged data due to problems of Sony Reader or computer.

On Copyrights

The contents of each book pre-installed on this product are copyrighted works, edited with the cooperation of the publisher and editor hereto mentioned.

Copyright laws prohibit copying the data of this product or the contents of this manual (illustrations, related documents, etc.) in whole or in part without the permission of the copyright holder. Additionally, use of the data of this product or the contents of this manual is not allowed without Sony's permission except for personal use.

- SONY and the SONY logo are trademarks of Sony Corporation.
- BBeB, BBeB Book, and their logos are trademarks of Sony Corporation.
- ℄ is trademark of Sony Corporation.
- CONNECT Reader and the CONNECT Reader logo are trademarks or registered trademarks of Sony Corporation.
- “Memory Stick,” “Memory Stick Duo,” “Memory Stick PRO,” “MagicGate Memory Stick,” and their logos are trademarks of Sony Corporation.
- Bitstream is a registered trademark, and Dutch, Font Fusion, and Swiss are trademarks, of Bitstream Inc.
- Microsoft, Windows, Windows NT, and Windows Media are trademarks or registered trademarks of Microsoft Corporation in the United States and/or other countries.
- Adobe, Adobe Reader and Adobe PDF are trademarks or registered trademarks of Adobe Systems Incorporated in the United States and/or other countries.

- MPEG Layer-3 audio coding technology and patents licensed from Fraunhofer IIS and Thomson.

- This product uses MontaVista Software, Inc.'s MontaVista(R) Linux(R) Professional Edition as the operating system.



COPYRIGHT ©1999-2006 MONTAVISTA SOFTWARE, INC. ALL RIGHTS RESERVED.

<http://www.mvista.com/>

- MontaVista is a registered trademark of MontaVista Software, Inc.

All other system names and product names appearing in this document are generally the registered trademarks or trademarks of their respective manufacturers. Further, the trademark TM and registered trademark ® symbols are not indicated throughout this document.

Program ©2006 Sony Corporation
Documentation ©2006 Sony Corporation

About GNU GENERAL PUBLIC LICENSE

Dear customers

Thank you for purchasing this product.

Included with this product is the following software which applies to GPL/LGPL. You may obtain, modify and redistribute the source codes of the software.

bash
fileutils

findutils
gcc
glib
glibc
grep
hardhatutils
hostname
mkcramfs
mtd-utils
mtools
ncurses
openssl
pam
procps
psmisc
sed
shellutils
sysutils
sysvinit
tar
textutils
time
util-linux

These source codes are available on the web site.
Access the following web site to download.

<http://www.sony.net/Products/Linux/>

Note that Sony accepts no inquiries concerning the contents of these source codes.

For details on GNU GENERAL PUBLIC LICENSE, refer to “gpl.txt” and “lgpl.txt” on the CD-ROM.

Specifications

Model name

PRS-500

Power source

Built-in rechargeable battery: DC IN 3.7 V

AC power adapter: DC IN 5.2 V

Battery life (continuous playback)

Approx. 7500 pages (when the battery is fully charged)

User available capacity

Approx. 64MB

Available storage capacity of Sony Reader may vary.

Operating temperature

5 to 35 °C (41 to 95 °F)

Dimensions (w/h/d)

Approx. 6.9 x 4.9 x 0.5 inches
(maximum, without soft cover)

Mass

Approx. 8.8 oz (without soft cover)

Optional Accessories

Cradle for Reader BCR-RU1

Design and specifications are subject to change without notice.

Index

Symbols

< button	9
> button	9
5-way control button	8

A

Audio file	45
------------------	----

B

Battery	16
BBeB Books	24
Bookmark	41
Book list	13, 32
Book types	34

C

Charge indicator	9
Charging	16
<i>See also</i> “Quick Start Guide”	
Collection	40
CONNECT eBooks	7, 22
CONNECT Reader	22, 24, 26, 28
Help	3
Install	
..... <i>See</i> “Quick Start Guide”	
Uninstalling	64

D

DC IN jack	10
Default settings	63

E

eBooks	7, 22, 34
ENT button	8

H

Headphone jack	10
Hole for hand strap	9
Home menu	13
Horizontal	37, 52

I

Import	22
Content	24
eBooks	22
Information	38

L

Link	37
------------	----

M

Manual	2
MARK button	9, 41

MARK LED	9, 41
Media slot	9, 18
Memory Card.....	18
“Memory Stick”	18, 73
MENU button	8, 13
Multi connector	10

N

NEXT button	9, 35
Number button.....	9, 32, 45, 49
Number tab.....	32, 45, 49

O

Option menu	13, 34
-------------------	--------

P

PAGE	9
Picture	49
POWER switch	9, 15

R

Reading books.....	32
while playing an audio file	47
Reset	57
Reset button.....	11, 57
Resume	16
RTF file	24, 35

S

SD Memory Card.....	18, 73
Setting	52
Orientation	52
Screen Lock	53
Slideshow.....	55
Version Information	56
SIZE button.....	9
Slideshow	51, 55
Soft cover attachment clip button	11
Sort.....	39
by Author.....	39
by Date.....	39

T

Table of contents	34
Transfer.....	26
Troubleshooting	57

U

Updating	65
USB	26
USB connector.....	10, 26

V

Vertical.....	37, 52
VOLUME button.....	9